

CERTIFICATE  
ESTABLISHING THE RATIFIED PLAN OF  
GOVERNMENT FOR THE TOWN  
OF BROADUS

As ratified by the voters on November 2nd, 1976, the government of the Town of Broadus, Montana, shall be organized under the following provisions of Section 47A-3-203, Revised Codes of Montana, 1947: Commission-Executive form.

- (1)
- (2)
- (3) (a) (ii)
- (3) (b) (iii)
- (3) (c) (ii)
- (3) (d) (ii)
- (3) (e) (ii)
- (3) (f) (ii)
- (3) (g) (ii)
- (3) (h) (i)
- (3) (j) (iii)
- (3) (k) (ii)
- (3) (l) (ii)
- (3) (m)
- (4) (a)

47A-3-203 Commission-executive form.

(1) The commission-executive form (which may be called the "council-executive," the "council-mayor," or the "commission-mayor" form) consists of an elected commission (which may be referred to as the "council") and one elected executive (who may be referred to as the "mayor") who is elected at large.

- (2) The executive shall:
  - (a) enforce laws, ordinances, and resolutions;
  - (b) perform duties required of him by law, ordinance, or resolution;
  - (c) administer affairs of the local government;
  - (d) carry out policies established by the commission;
  - (e) recommend measures to the commission;
  - (f) report to the commission on the affairs and financial condition of the local government;
  - (g) execute bonds, notes, contracts, and written obligations of the commission, subject to the approval of the commission;
  - (h) report to the commission as the commission may require;
  - (i) attend commission meetings and may take part in discussions;
  - (j) execute the budget adopted by the commission;
  - (k) appoint, with the consent of the commission, all members of boards; except, the executive may appoint without the consent of the commission temporary advisory committees established by the executive.



(3) The plan of government shall further define the structural characteristics of the form by including the items listed below:

(a) The executive may appoint one or more administrative assistants to assist in the supervision and operation of the local government. Such administrative assistants shall be answerable solely to the executive.

(b) The executive may appoint, with the consent of a majority of the commission, all department heads. The executive may remove department heads and may appoint and remove all other department employees.

(c) The executive may veto ordinances and resolutions subject to override by a two-thirds vote of the commission.

(d) The executive may prepare the budget in consultation with the commission and department heads.

(e) The executive may exercise control and supervision of all departments and boards to the degree authorized by ordinance of the commission.

(f) a financial officer (who may be called the "treasurer") shall be appointed.

(g) The commission shall be elected by districts in which candidates must reside and which are apportioned by population.

(h) Local government elections shall be conducted on a partisan basis as provided in this title.

(i) The commission shall have a chairman who shall be elected by the members of the commission from their own number for a term established by ordinance.

(j) The presiding officer of the commission shall be the executive who shall decide all tie votes of the commission, but shall have no other vote. The chairman of the commission shall preside if the executive is absent.

(k) Commission members shall be elected for overlapping terms of office.

(l) The size of the commission shall be four (4) members, two (2) to be elected from each of two (2) districts, and community councils to advise commissioners may be authorized by ordinance.

(m) The term of office of elected officials shall be four (4) years.

(4) The plan of government shall authorize general government powers.



WE, EVELYN H. KRAFT, Chairman, and Edith M. McLain, and Elna Linville, Commission members, of the Town of Broadus Local Government Study Commission, do hereby certify that this is the Plan of Government as ratified by the voters.

IN TESTIMONY WHEREOF, WE set our hands this 15 day of November, 1976, at Broadus, Montana.

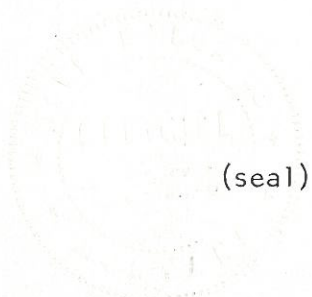
  
(seal)

Evelyn H. Kraft  
Evelyn H. Kraft, Chairman

Elna Linville  
Elna Linville-Commission Member

Edith M. McLain  
Edith M. McLain-Commission Member

ATTEST:

Nolana J. Beach

Nolana J. Beach  
Town Clerk, Town of Broadus, Montana



LIMITS OF THE VARIOUS WARDS

WARD I.

Blocks 1,2,3,4,5, and 6 of the Trautman Addition to Broadus as shown on Recorded Instrument No. 3783 and Blocks 1,2,5,6,7, 8,11,12,13,14,17, and 18 of the Original Townsite of Broadus as shown on Recorded Instrument No. 667. Also Lots 1,2,3, and 4 bordering on the South side of South Street as shown on map annexed hereto and also four pieces of property bordering Trautman Avenue on the East side and shown on the map annexed hereto as the F.W. Trautman, J.P. Miller and Jack Smith properties. Plus all property within town limits East of Park Avenue and High-way No. 212.

WARD II.

Blocks 7,8,10,11, and the East Half of Blocks 12 and 13 of the Trautman Addition to Broadus as shown on Recorded Instrument No. 3783 and Blocks 3,4,9,10,15 and 16 of the Original Townsite of Broadus as shown on Recorded Instrument No. 667. Plus all property within town limits West of Park Avenue and High-way No. 212.

TOWN OF BROADUS, STATE OF MONTANA

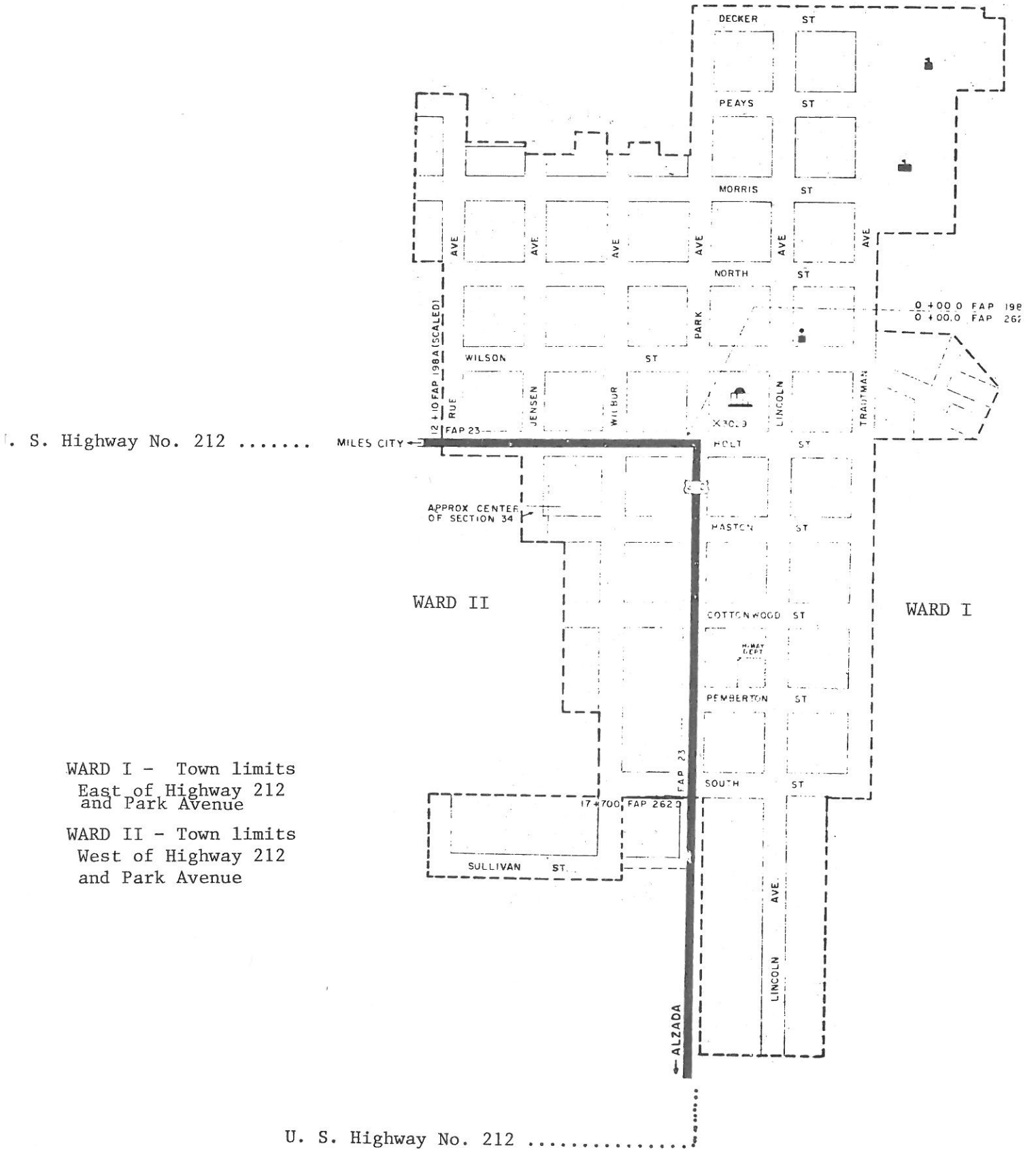

WARD I - Town limits  
East of Highway 212  
and Park Avenue

WARD II - Town limits  
West of Highway 212  
and Park Avenue



CERTIFICATE OF OFFICIAL APPORTIONMENT PLAN FOR WARDS

WE, THE STUDY COMMISSION of Broadus, Montana, do hereby certify that this is the official apportionment plan for wards approved by the Study Commission of Broadus, Montana.

IN TESTIMONY WHEREOF, We set our hands.

Done at Broadus, Montana, this 30th day of July, 1976.

(Seal)

ATTEST:

/s/ Nolana J. Beach  
Town Clerk of Broadus, Montana

/s/ Evelyn H. Kraft

/s/ Elna Linville

/s/ Edith M. McLain  
LOCAL GOVERNMENT STUDY COMMISSION

